

Ruby Priore  
OMHCI Show Manager  
41691 West Highway 16  
Bristow, OK 74010

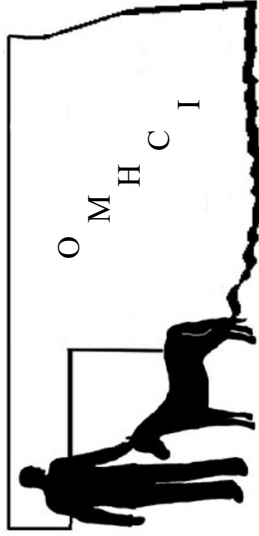

**Come and join us for our AMHR/Pony/PtHA Mini Stampede Show - May 17 & 18, 2025**

The  
Oklahoma Miniature Horse Club, Inc.

Presents the

# *Mini Stampede*

*AMHA Miniature Horse Show  
& ABRA Miniature World Show*



**May 18, 2025**

Heart Of Oklahoma Expo Center  
1700 West Independence Street  
Shawnee, Oklahoma 74804

**Pre-Entries Close May 1, 2025**



## Help the Youth Program & Win a Miniature Horse!

We will be having a drawing for a miniature horse on Saturday, May 17th during the lunch break. Tickets are \$20 each or 6 for \$100, and help to benefit the OMHCI Youth Program. You MUST be present to win, and make arrangements to take the horse home with you on Sunday by the end of the show. Check the website at [www.OMHCI.org](http://www.OMHCI.org) closer to show date for further details on the horse.

**OMHCI now accepts credit cards.**  
5% Service Fee will be applied.

### ATTENTION YOUTH: For club members only...

OMHCI Youth sponsored members will be eligible to have their class entries paid for at the RRS, MS LCS shows. There is a membership form on the OMHCI website or available at the show if you would like to take advantage of this offer. All other fees; i.e. - office, stall, shavings charges must still be paid by the exhibitor.

**OMHCI is giving away Door Prizes!!!**  
Come and show to be eligible for several drawings to be held throughout the show - must be present to win.  
Various types of door prizes will be given away.



### FOUR SHOWS IN ONE WEEKEND -

#### JOIN US FOR THE AMHR/Pony/PtHA SHOW!

Make this a combination show weekend for your registered AMHR, AMHA, ABRA or PtHA horse's points. The AMHR/PtHA show will begin at 8:00 a.m. on Saturday morning. The AMHA/ABRA show will begin at 8:00 a.m. on Sunday morning. See the OMHCI website for details, premiums and entry forms; separate paperwork and entry fees will apply for AMHR, AMHA, ABRA and PtHA Shows. Contact the Show Manager if you have questions.

### PRE-SHOW PAID PRACTICE

Join us on Friday evening, before the show for our pre-show paid practice warm-up. Various jumps and obstacles will be set up so that you may practice the night before our show begins. Cost is \$15 per equine and you may practice for as long as you like. You may add this onto your entry form or if you decide to practice once you get to the show, you may pay at the show office. This practice is open to registered or unregistered miniature equines (including miniature donkeys, mules or ponies). No show clothes necessary but all other show requirements (current health papers/Negative Coggins) apply.

### 2025 CIRCUIT AWARD

Come to all three 2025 OMHCI shows - April, May and August to be eligible for the Overall High Point show circuit champion award. A PLATED BLANKET BAG will be given to the overall high point winning AMHA circuit champion horse. Donated by Starlite Ranch. Horses MUST be shown in a minimum of 3 classes at each show to be eligible (halter, color, showmanship, liberty, hunter, jumper, obstacle and driving). Award will be presented to the winner at the August Last Chance Showdown show.

**Directions to the Expo Center:** The Expo Center is located 4 miles Southeast of I-40 (Exit 181) and Hwy. 177, then turn East at the stop light on Leo St. The exact address is Heart Of Oklahoma Expo Center, 17 West Independence Street, Shawnee, Ok 77804; (405)-275-7020. There is a downloadable map on the Expo Center website - [ShawneeExpo.com](http://ShawneeExpo.com). Wi-Fi is available at the Expo Center. The arena is indoors but not climate controlled.

**IMPORTANT - Absolutely NOTHING** may be **TAPED, STAPLED, or NAILED** onto ANY surface, including stalls, on the grounds except on the designated bulletin boards.

Otherwise fines will be imposed. Please help keep the facility clean. Please place trash and manure in the dumpsters outside. NO GLASS CONTAINERS and alcohol is not permitted. Thanks!

**Stall Assignments** - stalls will be available by 12:00 p.m. on Friday, May 16, and must be vacated by 10:00 p.m. on Sunday, May 18. These are 10' x 10' stalls, and all have concrete floors. No more than two horses will be allowed in a stall. Stallions 2 years and older MUST be stalled separately. If you wish to stay over prior arrangements must be made in advance and additional fees may apply. The horse show office, arena, restrooms and concession are all located in the same building; there are three large warm-up areas between the arena and the stall barn. There are multiple indoor wash racks.

Shavings may be purchased at the Show Office or pre-purchased on the entry form.

**No outside bedding may be brought onto the show grounds.**

**Lunch break** - will be announced at a time determined by the Show Manager.

**Concession** - will be available on Sat & Sun. Pizza will be available without cost to the exhibitors and show staff on Friday evening near the Show Office.

**Dogs** - MUST be kept on a leash or penned at all times; and animals are NOT allowed in the show office and concession area.

**Smoking** - is NOT permitted inside the office, barns or arena areas.

**RV Hookups:** There are 30 and 50 AMP RV Hookups available on the grounds.

There is also water available and a dump station on site, and numerous comfort stations with showers.

**Trailer Parking:** Please park your trailers to the north, west or south of the stall/arena barns; vehicles ONLY in the east lot.

**Host Hotel:** When booking your rooms, please let the hotel know you are with the Miniature Horse Show.

**Hampton Inn - Shawnee** - Check in is 3 p.m. & check out is at 11 a.m. Free breakfast buffet and Wi-Fi is included. Restaurants and shopping nearby. Indoor pool; exercise room. Pets allowed for an extra charge. Non-Smoking, Laundry Services, Children's Activities. Located off of Kickapoo Ave and South of I-40 (Exit 185).

4851 North Kickapoo Ave.  
Shawnee, OK 74801

Phone: (405)-275-1540



**OTHER AREA HOTELS:** (Located approximately 3-7 miles from the Expo Center)

**Baymont By Wyndham - Shawnee:** 4981 N. Harrison St; Shawnee (405)-585-0733 Ck in 3 pm/out at 11 am (Free Breakfast & Wi-Fi) - Outdoor Pool. No pets.

**Colonial Inn:** 4700 N. Harrison St; Shawnee (405)-878-0120 Ck in 2 pm/out at 11 am (Free Wi-Fi; Non-refundable pet deposit) - No Breakfast. No Pool

**Comfort Inn & Suites Shawnee North I-40:** 5400 Enterprise Ct; Shawnee (405)-310-0993 Ck in 3 pm/out at 11 am (Free Breakfast & Wi-Fi; No pets) - Indoor Pool

**Days Inn By Wyndham - Shawnee:** 5107 N. Harrison St; Shawnee (405)-275-6720 Ck in 3 pm/out at 11 am (Free Breakfast & Wi-Fi, No pets) - No Pool

**Fairfield Inn & Sts - Marriott Shawnee:** 14012 Transportation Pkwy; Shawnee (405)-943-2700 Ck in 3 pm/out at Noon (Free Breakfast & Wi-Fi, No pets) Indoor Pool

**Grand Casino Hotel & Resort:** 777 Grand Casino Blvd; Shawnee (405)-967-7777 Ck in 3 pm/out at 11 am (Free Wi-Fi; No pets) Restaurant-Breakfast w/extra charge & Bar. Outdoor Pool & Spa.

**Holiday Inn Express & Suites Shawnee:** 4909 North Union Ave; Shawnee (405)-275-8880 Ck in 3 pm/out at Noon (Free Breakfast & Wi-Fi, No pets) Restaurant-Bar - Outdoor Pool & Hot Tub

**LaQuinta Inn & Suites By Wyndham Shawnee:** 5401 Enterprise Ct; Shawnee (405)-275-7930 Ck in 3 pm/out at Noon (Free Breakfast & Wi-Fi; Non-refundable pet deposit) Restaurant. Indoor Pool & Hot Tub

**Super 8 By Wyndham - Shawnee:** 5104 N. Harrison St; Shawnee (405)-432-1528 Ck in 3 pm/out at 11 am (Free Breakfast & Wi-Fi; Non-refundable pet deposit) No Pool.

The other hotels have been listed for your convenience, but not all are necessarily recommended.



**Attention Buckskin Mini Owners**  
**THE ABRA MINI WORLD SHOW IS HERE!!!!**

OMHCI has become a charter member club to the American Buckskin Registry Association (ABRA). You will now be able to become a member and register your miniatures and ponies of buckskin, dun, red dun or grulla coloration with ABRA. Also miniatures and ponies that have at least one registerable ABRA parent (even if not registered) but the offspring miniature or pony does not meet the regular buckskin requirements, may be registered under the ABRA buckskin bred registry program.

**On-site horse registry and memberships will be available at the show.**

OMHCI is looking to promote these horses this year by offering pointed ABRA WS classes that will run in among your regular AMHA classes. Separate ABRA class and association fees will be incurred.



**ABRA WORLD SHOW ENTRY FEES:** owners and exhibitors MUST be ABRA members  
 Open Classes - \$75 **PRE-ENTRY DUE MAY 1, 2025** LATE FEE \$100/per class  
 Office Fee - \$20 per horse

All other OMHCI fees remain the same.

**CLASS ENTRIES MUST BE MADE THROUGH ABRA - [www.AmericanBuckskin.com](http://www.AmericanBuckskin.com)** under World Show  
**STALLS & SHAVINGS MUST BE MADE THROUGH OMHCI - [www.omhci.org](http://www.omhci.org)** on the forms page  
 (if not already entered in AMHR/AMHA Shows)

If you have any questions please contact:

Ruby Priore; OMHCI Show Manager at (918)-576-1452 or at [PintoHorseLady@yahoo.com](mailto:PintoHorseLady@yahoo.com) - or -  
 Rebecca Roberts; ABRA Office at (918)-936-4707 or at [AmericanBuckskin@gmail.com](mailto:AmericanBuckskin@gmail.com)



**AMHA SHOW FEE SCHEDULE:**

- Open Classes\* - \$35/class or flat fee of \$175.
- Amateur Classes\* - \$30/class or flat fee of \$150.
- Youth Classes\* - FREE to OMHCI sponsored members or \$15/class or flat fee of \$75.
- \*one exhibitor/horse combination ONLY for each flat fee/per show division - after that, regular rates apply. **\$50 Crossover fee to add a division or exhibitor. Late entries are not eligible for the flat fees.**
- Novice Classes\*\* (non-pointed\*\*).....\$15
- Pre-Show Warm-Up Practice (Friday night only).....\$15
- AMHA Office Fee** (includes the AMHA Surcharge) - per horse.....\$20
- Early/Late Stall Fee (\$35/stall/night); may apply for early check-in or lay-over
- Tie-Out Fee - per horse/day - (ANY horses not stalled).....\$35
- Shavings** - per bag (1 bag minimum required).....\$10
- Late Fee Per Horse** - for entries postmarked or made after 5/1/25.....\$30
- Returned Check Fee.....\$45
- RV Hookup - per night.....\$55  
 (30, & 50 AMP; with water available & dump station on site)
- Show Supporter - Platinum/\$1K +, Gold/\$500+, Silver/\$100+, Bronze/\$50+
- Class Supporter - Regular Class.....\$10  
 Championship or Stakes per Division .....\$30
- Banner Supporter - (2' x 4').....\$50
- Youth Fund or Scholarship Program.....ANY AMOUNT WELCOME

Entries postmarked after 5/1/2025, new entries, entries made or added at the show will be charged a late fee. No refunds given on scratched classes.

**SEE ENTRY FORM for any detailed information.**

**WARNING:** Under Oklahoma Law, an equine professional is not liable for an injury to, or the death of, a participant in equine activities resulting from the inherent risks of equine activities.

**WE MAY BE SHARING THE FACILITY WITH OTHER EVENTS - PLEASE CHECK WITH THE SHOW OFFICE BEFORE PARKING YOUR TRAILERS OR RV'S.**

**PRE-ENTRIES CLOSE MAY 1, 2025**

*Welcome to the Mini Stampede*

*AMHA Miniature Horse Show &*

*ABRA Miniature World Horse Show*

**May 18, 2025**

Heart Of Oklahoma Expo. Center  
 1700 West Independence St.  
 Shawnee, OK 74804



Sponsored by the  
 Oklahoma Miniature Horse Club, Inc. (OMHCI)

Show Manager: Ruby Priore  
 (918)-576-1452/Cell (918)-367-5035/Home  
 EM: [PintoHorseLady@yahoo.com](mailto:PintoHorseLady@yahoo.com) (918)-367-5143/Fax

**Pre-Entries Close May 1, 2025**



**JUDGES:**

Chris Bickford; OR - Senior  
 Doug LaSota; AZ - Senior  
 Kim Seipp; CO - Senior



This miniature horse show is approved by and conducted under the rules of the American Miniature Horse Association (AMHA), Alvarado, TX. All horses MUST be registered with AMHA. **A legible copy of both sides of the Certificate of Registration of each horse entered must be submitted to the Show Manager with each horse entry.** Entries that are received without a copy of both sides of the registration papers will be held pending until such papers are submitted. A copy of lease (with AMHA stamp) for horses showing that are being leased. For geldings, gelding status must be reflected on the Certificate of Registration in order to show in any AMHA class. Along with your registration papers, please send a copy of your Stallion Testicular Report for any senior stallion entered. No youth under 12 years of age may show stallions, except weanling or yearling colts. No cross entry is allowed between single pleasure, country pleasure or classic pleasure driving - this includes open, amateur, and youth. AOTE & YOTE horses must be registered to the exhibitor on January 1 of the year being shown, to be eligible to show in the perspective AOTE & YOTE classes. **Also necessary are current Youth and Amateur AMHA cards,** (and provide numbers on the entry form) **and a CURRENT NEGATIVE COGGINS;** also a current health certificate within 30 days of the show. Youth and Amateur cards may be applied for through AMHA or at the horse show office.

## Show Banner Sponsors

For those who would like to have a banner made to hang at the shows and other OMHCI events for the calendar year; the cost would be \$100. These are 2' x 4' banners and can be made up in several different colors. Please get your orders in early as it will take at least 2 weeks to get them made, and to have them available for all OMHCI events.

If you already have your own banner and would like to have it hung at events and shows the cost would be \$50. Any pre-owned banners larger than 2' x 4' will require prior approval and may be subject to a higher fee. So show off your farm, business, or horses by advertising with your banner!

Please contact the show manager, Ruby Priore at (918)-576-1452 for details.

## ENCLOSE WITH YOUR COMPLETED ENTRIES:

1. Legible copy of EACH horse's AMHA registration papers, FRONT & BACK.
2. Copy of Stallion Inspection Certificate on Senior Stallions.
3. Copy of lease (with AMHA stamp), if you are showing a leased horse.
4. Copy of current (2025) AMHA Youth/Amateur card. (These may be applied for through AMHA or at the horse show office).
5. A check for all fees payable to: **OMHCI**.

All horses are required to have a negative coggins within 12 months and a health certificate within 30 days. DO NOT send these in with your paperwork, but bring them to the show; as you will NOT be able to show without them.

MAIL COMPLETED ENTRY FORMS WITH THE ABOVE LEGIBLE PAPERWORK TO:  
Ruby Priore; AMHA Red River Shoot-Out Show Manager (918)-576-1452/cell  
41691 West Hwy. 16 (918)-367-5035/home  
Bristow, OK 74010 (918)-367-5143/fax

Email (for contact only): PintoHorseLady@yahoo.com

**PLEASE NOTE: ALL entries must be MAILED in and accompanied with the proper legible paperwork and required payment or an open check must be left on file in the show office.**

Entries must be mailed in by the pre-entry or they will be subject to late fees. Trainers please include your contact information.

**WE MAY BE SHARING THE FACILITY WITH OTHER EVENTS - PLEASE CHECK WITH THE SHOW OFFICE BEFORE PARKING YOUR TRAILERS OR RV'S.**

**EMPTY TRAILERS MAY BE PARKED ON THE NORTH, SOUTH OR WEST SIDES OF THE BARN - VEHICLES ONLY MAY BE PARKED IN THE EAST PARKING LOT.**

### ALL MEASUREMENT TIMES

Friday, May 16 - 4:00 to 8:00 p.m.; and from 7:00 to 7:30 a.m. Saturday, May 17 and Sunday, May 18; or for 30 minutes following the last class of the show on Saturday. If you can't measure within these hours, contact the Show Manager. ALL Entry materials MUST be in the Show Office before measurements will be made. ALL horses entered MUST be measured before they may be allowed to show. **ALL HORSE CARDS/PAPERWORK MUST BE CHECKED AND RECORDED AT THE MEASUREMENT STATION BEFORE YOU GET YOUR PACKET.** Please bring color copies of your horse papers AND original measurement cards with you to the measurement station.

## PLEASE MAKE NOTE:

The Show Manager reserves the right to settle and determine all questions, differences and disputes arising out of or connected with or incident to this show; and to cancel or combine classes of this Show within the boundaries of AMHA's current show rules. Cruelty, abuse or inhumane treatment of any horse in the show ring, barn, stalls or on the grounds is strictly prohibited. The use of stimulants or depressants or any drug affecting the showing of a horse is forbidden.

**NO LOGO'S, NAMES OR OTHER IDENTIFICATION OF PERSON OR FARM WILL BE ALLOWED ON ANY EXHIBITOR, HORSE OR VEHICLE IN THE SHOW ARENA.**

**WARNING:** Under Oklahoma Law, an equine professional is not liable for an injury to, or the death of, a participant in equine activities resulting from the inherent risks of equine activities.

### RETURNED CHECK FEE

OMHCI will charge a \$45.00 return check fee on all checks returned.

### REFUND POLLICY

A full refund will be given if entries are cancelled **in writing to the show manager before the closing date of the pre-entries**. If entries are cancelled in writing accompanied by a veterinarian's or a doctor's certificate of inability to show. After the closing date of pre-entries, but before the official start of the show, all fees other than the stall and office fees will be refunded. After the official start of the show, there will be no refunds. Substitution of a horse will be accepted with no late fee.

### LIBERTY TAPES & CD's

Management is NOT responsible for any loss or damage to Liberty music. It is PREFERRED for there to be one CD or tape PER ENTRY. If there is any question as to if your CD will work on the show equipment, please have it checked with show management before turning it in for the Liberty class.

**SHOW & CLASS SPONSORS** - The cost of sponsoring a regular class is \$10 per class. Grand & Reserves, Supreme and Amateur & Youth High Points sponsorship is \$30 per division. Sponsors will be acknowledged during the show and are welcome to present awards for their classes. Sponsorships may be paid on the entry form; or on the class sponsorship form in the show office. Show sponsor levels are Platinum \$1K+, Gold \$500+, Silver \$100+ and Bronze \$50+ to be advertised at the show and on the website.

**JUDGE'S EVALUATION FORMS** - are no longer mandatory, but they may be filled out on a voluntary basis. Forms are available in the Show Office.

### Awards

- Awards 1st through 6th place
- Awards for Grand and Reserve Grand Champions
- Awards for Open and Amateur Supreme Champions
- Awards for Overall Youth & Amateur High Point and Reserve High Point



- \* Denotes non-pointed class.
- \*\* Denotes non-rated AMHA class.

**All Buckskin classes have a separate entry form, and class fees. Horses, owners and exhibitors must be members of ABRA.**

### FT. WORTH SHAVER

Be sure to bring your clipper blades to be sharpened or purchase new ones. **Bill Thweatt: (817)-897-0372**

**Sunday - Continued:**

- 164. Senior Stallion, 28" & under {1097}
- 165. Senior Stallion, over 28" up to & including 30" {1096}
- 166. Senior Stallion, over 30" up to & including 32" {1095}
- 167. Senior Stallion, over 32" up to & including 34" {1094}
- 168. **Grand and Reserve Champion Senior Stallion** {1458}  
(1st & 2nd in Classes 164-167)
- 32WS. ABRA Mini A/B - Open Halter Stallions (All Ages) {610111}
- 33WS. ABRA BBP Mini A/B - Open Halter Stallions (All Ages) {810111}
- 169. Multi Color Stallion and Gelding {1131}
- 170. Solid Color Stallion and Gelding {1132}
- 34WS. ABRA Mini A/B Buckskin Color (All Ages; All Sexes) {610182}
- 35WS. ABRA Mini A/B Dun Factor (All Ages; All Sexes) {610181}
- 171. **Amateur Supreme Halter Champion\***  
(1st in Classes 34, 82 & 145)
- 172. **Supreme Halter Champion** {1352}  
(1st in Classes 28, 41, 63, 88, 125, & 168)



\* Denotes non-pointed class.  
\*\* Denotes non-rated AMHA class.

Join the Stampede... Be sure to check out the website -  
**www.OMHCI.org**  
or follow us on Facebook - **OMHCI**



## 2025 Show Schedule

- OMHCI Clinic/"Fat N Fuzzy" Fun Show, Otto Barn - Shawnee, OK; March 29  
Clinic Subject - Balance and Body Control of the Horse/Bryce Baker
- OMHCI Red River Shoot-out AMHR/Pony/ABRA/PtHA-Shawnee, OK; April 26&27
- OMHCI Red River Shoot-out AMHA/ABRA Show - Shawnee, OK; April 27
- OMHCI Mini Stampede AMHR/Pony/PtHA Show - Shawnee, OK; May 17 & 18
- OMHCI Mini Stampede AMHA/ABRA Mini World Show - Shawnee, OK; May 18
- OMHCI Last Chance Showdown AMHR/Pony Show - Shawnee, OK - Aug. 2 & 3
- OMHCI Last Chance Showdown AMHA Show - Shawnee, OK - Aug. 3
- AMHA Central Regional Championship Show - TBA
- AMHA World Championship Show - Ft. Worth, TX - TBA

*OMHCI Awards Banquet and Christmas Party - December 6th*

### LOCAL VETERNARIANS:

#### *Shawnee Animal Hospital*

(405)-275-0990; 1509 N. Kickapoo St.  
After Hours Emergency: Lg. Animal: (405)-481-9392;  
Sm. Animal: (405)-631-7828

#### *Ellis & Bellinger Veterinary Services*

39002 Hardesty Road  
(405)-275-6498; Clinic & 24 Hours

*Come one and all - Join the Stampede for the Exhibitor Appreciation Pizza Party!*  
**Come join us Friday night around 6:00 p.m. near the horse show office.**

*Get your horses measured, check-in, and grab a slice of pizza and a cold drink!*



### Attention Pinto Mini and Pony Owners

You will now be able to become a member and register your spotted miniatures and ponies with the Pinto Horse Association of America (PtHA). Also miniatures and ponies that do not meet the regular pinto requirements, may be registered under the PtHA solid bred registry program.

**On-site horse registry and memberships will be available at the show on Saturday (for A & R Horses).**

OMHCI is looking to promote these horses this year by offering pointed PtHA classes that will run in between your regular **AMHR** classes. Separate PtHA class and association fees will be incurred.

**PtHA SHOW ENTRY FEES:** \*one horse/any exhibitor - (owners and exhibitors **MUST** be PtHA members)

Open Classes - \$30 or \$150 flat fee\*

Office Fee - \$20 per horse

Pinto Fee - \$15 per horse

Measurement Card - \$5 Annually; if not already measured or have permanent measurement card.

(**MUST** show Annual Certificate or Permanent Measurement Card at the show)

All other OMHCI fees remain the same.

If you have any questions please contact:

Ruby Priore; OMHCI Show Manager at (918)-576-1452 or at PintoHorseLady@yahoo.com

## YOUTH SILENT AUCTION

*We will be having a Silent Auction during the show to help benefit the OMHCI Youth Fund. So please bring some nice things to donate and a few extra dollars to bid on the auction items.*

*The auction will close on Saturday afternoon.*

*PLEASE REMEMBER these funds help make things possible that bring our youth closer together. Your contributions help secure and support the future of our youth!*



**Don't forget to patronize our show vendors!**



**PRE-ENTRIES CLOSE MAY 1, 2025**

## Mini Stampede AMHA/ABRA Miniature Horse Show - Schedule of Classes:

### Sunday - Begins at 9:00 a.m. Or following AMHR class #443.

1. Youth Costume, 18 years & under {1174}  
1WS. ABRA Mini A/B & BBP - Open Costume {Non-Pointed}
2. Youth Obstacle Driving, 12 years & under {1198}
3. Youth Obstacle Driving, 13 - 18 years {1199}
4. Amateur Obstacle Driving {1200}
5. Open Obstacle Driving {1205}  
2WS. ABRA Mini A/B - Open Obstacle Driving {610004}  
3WS. ABRA BBP Mini A/B - Open Obstacle Driving {810004}
6. Novice Halter Obstacle - Any Age Novice Exhibitor\*
7. Youth Halter Obstacle, 12 years & under {1154}
8. Youth Halter Obstacle, 13 - 18 years {1157}
9. Amateur Halter Obstacle {1180}
10. Open Halter Obstacle {1182}  
4WS. ABRA Mini A/B - Open Halter Obstacle {610112}  
5WS. ABRA BBP Mini A/B - Open Halter Obstacle {810112}
11. Novice Halter Mare - Any Age Novice Exhibitor\*
12. Youth Halter Mare, 7 years & under {1006}
13. Youth Halter Mare, 8 - 12 years {1007}
14. Youth Halter Mare, 13 - 18 years {1008}
15. Youth Stock Type Mare; All Ages, 18 years & under {1415}
16. Amateur Junior Mare, 30" & under, Level 1 {1018}
17. Amateur Junior Mare, over 30" up to & including 33", Level 1 {1019}
18. Amateur Junior Mare, 30" & under, Level 2 {1023}
19. Amateur Junior Mare, over 30" up to & including 33", Level 2 {1024}
20. AOTE Junior Mare, 33" & under {1283}
21. Weanling Mare, 30" & under {1033}
22. Yearling Mare, 28" & under {1040}
23. Yearling Mare, over 28" up to & including 30" {1043}
24. Yearling Mare, over 30" up to & including 32" {1044}
25. Two Year Old Mare, 29" & under {1050}
26. Two Year Old Mare, over 29" up to & including 31" {1051}
27. Two Year Old Mare, over 31" up to & including 33" {1052}
28. **Grand and Reserve Champion Junior Mare** {1453} (1st & 2nd in Classes 21-27)
29. Amateur Senior Mare, 30" & under, Level 1 {1026}
30. Amateur Senior Mare, over 30" up to & including 34", Level 1 {1025}
31. Amateur Senior Mare, 30" & under, Level 2 {1023}
32. Amateur Senior Mare, over 30" up to & including 34", Level 2 {1024}
33. AOTE Senior Mare, 34" & under {1284}
34. **Grand and Reserve Champion Amateur Mare** {1451} (1st & 2nd in Classes 16-20 & 29-33)
35. Amateur Stock Type Mare; All Ages - 34" & under {1417}
36. Stock Type Mare; All Ages - 34" & under {1420}
37. Senior Mare, 28" & under {1056}
38. Senior Mare, over 28" up to & including 30" {1055}
39. Senior Mare, over 30" up to & including 32" {1054}
40. Senior Mare, over 32" up to & including 34" {1053}
41. **Grand and Reserve Champion Senior Mare** {1454} (1st & 2nd in Classes 37-40)  
6WS. ABRA Mini A/B - Open Halter Mares (All Ages) {610109}  
7WS. ABRA BBP Mini A/B - Open Halter Mares (All Ages) {810109}
42. Multi Color Mare {1129}
43. Solid Color Mare {1130}



### **Sunday - Continued:**

126. Youth Country Pleasure Driving, 12 years & under {1276}
127. Youth Country Pleasure Driving, 13 - 18 years {1277}
128. Country Pleasure Driving Mare {1325}
129. Country Pleasure Driving Gelding {1326}
130. Country Pleasure Driving Stallion {1324}
131. Amateur Country Pleasure Driving, Level 1 {1273}
132. AOTE Country Pleasure Driving {1314}
133. Amateur Country Pleasure Driving, Level 2 {1274}
134. Country Pleasure Driving, 32" & under {1248}
135. Country Pleasure Driving, over 32" to 34" {1249}
136. Country Pleasure Driving, 3 & 4 year old {1355}
137. Ladies' Country Pleasure Driving {1321}
138. Gentlemen's Country Pleasure Driving {1322}
139. **Grand and Reserve Champion Country Pleasure Driving** {1334}  
(1&2 in Classes 126 - 138)  
28WS. ABRA Mini A/B - Open Country Pleasure Driving {610668}  
29WS. ABRA BBP Mini A/B - Open Country Pleasure Driving {810668}
140. Amateur Senior Stallion, 30" & under, Level 1 {1069}
141. Amateur Senior Stallion, over 30" up to & including 34", Level 1 {1070}
142. Amateur Senior Stallion, 30" & under, Level 2 {1067}
143. Amateur Senior Stallion, over 30" up to & including 34", Level 2 {1068}
144. AOTE Senior Stallion, 34" & under {1293}
145. **Grand and Reserve Champion Amateur Stallion** {1452}  
(1st & 2nd in Classes 110-114 & 140-144)
146. Youth Classic Pleasure Driving, 12 years & under {1368}
147. Youth Classic Pleasure Driving, 13 - 18 years {1369}
148. Classic Pleasure Driving Mare {1374}
149. Classic Pleasure Driving Gelding {1375}
150. Classic Pleasure Driving Stallion {1373}
151. Amateur Classic Pleasure Driving, Level 1 {1361}
152. AOTE Classic Pleasure Driving {1363}
153. Amateur Classic Pleasure Driving, Level 2 {1362}
154. Classic Pleasure Driving, 32" & under {1365}
155. Classic Pleasure Driving, over 32" to 34" {1366}
156. Classic Pleasure Driving, 3 & 4 year old {1386}
157. Ladies' Classic Pleasure Driving {1377}
158. Gentlemen's Classic Pleasure Driving {1376}
159. **Grand and Reserve Champion Classic Pleasure Driving** {1336}  
(1&2 in Classes 146 - 158)  
30WS. ABRA Mini A/B - Open Classic Pleasure Driving {610672}  
31WS. ABRA BBP Mini A/B - Open Classic Pleasure Driving {810672}
160. Amateur Stock Type Stallion; All Ages - 34" & under {1418}
161. **Grand and Reserve Champion Amateur Stock Type Halter** {1430}  
(1st & 2nd in Classes 35, 83 & 160)
162. Stock Type Stallion; All Ages - 34" & under {1421}
163. **Grand and Reserve Champion Stock Type Halter** {1462}  
(1st & 2nd in Classes 36, 84 & 162)

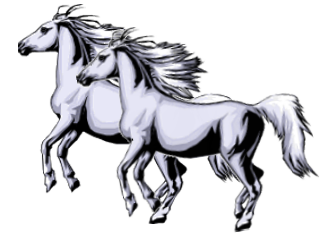

**Don't forget to join us  
in August for the  
Last Chance Showdown and  
next season for the Fat N Fuzzy  
Spring Training Show**



**Sunday - Continued: \*\*\*\*BREAK\*\*\*\***

- 89. Youth Hunter, 12 years & under {1184}
- 90. Youth Hunter, 13 - 18 years {1185}
- 91. Amateur Hunter {1186}
- 92. Open Hunter {1188}
- 14WS. ABRA Mini A/B - Open Hunter In Hand Over Fences {610177}
- 15WS. ABRA BBP Mini A/B - Open Hunter In Hand Over Fences {810177}
- 93. Youth Jumper, 12 years & under {1190}
- 94. Youth Jumper, 13 - 18 years {1191}
- 95. Amateur Jumper {1192}
- 96. Open Jumper {1194}
- 16WS. ABRA Mini A/B - Open Jumper In Hand {610005}
- 17WS. ABRA BBP Mini A/B - Open Jumper In Hand {810005}
- 97. Youth Special Needs Showmanship, 18 years & under {1252}
- 98. Adult Special Needs Showmanship {1255}
- 99. Youth Showmanship, 7 years & under {1121}
- 100. Youth Showmanship, 8 - 12 years {1122}
- 101. Youth Showmanship, 13 - 18 years {1123}
- 102. Amateur Showmanship {1125}
- 103. Adult Showmanship {1126}
- 18WS. ABRA Mini A/B - Open Showmanship {610871}
- 19WS. ABRA BBP Mini A/B - Open Showmanship {810871}
- 104. Liberty {1196}
- 20WS. ABRA Mini A/B - Liberty {610003}
- 21WS. ABRA BBP Mini A/B - Liberty {810003}
- 105. Special Needs Driving {1332}
- 106. Reinsmanship\*\* {1359}
- 22WS. ABRA Mini A/B - Reinsmanship {610006}
- 23WS. ABRA BBP Mini A/B - Reinsmanship {810006}
- 107. Youth Versatility {1387}
- 108. Versatility {1331}
- 24WS. ABRA Mini A/B - Versatility {610007}
- 25WS. ABRA BBP Mini A/B - Versatility {810007}
- 109. Novice Halter Stallion - Novice Exhibitor, 12 years & older\*
- 110. Amateur Junior Stallion, 30" & under, Level 1 {1063}
- 111. Amateur Junior Stallion, over 30" up to & including 33", Level 1 {1062}
- 112. Amateur Junior Stallion, 30" & under, Level 2 {1060}
- 113. Amateur Junior Stallion, over 30" up to & including 33", Level 2 {1061}
- 114. AOTE Junior Stallion, 33" & under {1292}
- 115. Carriage Driving Pleasure {1459}
- 116. Carriage Driving Working {1461}
- 117. Carriage Driving Reinsmanship {1460}
- 26WS. ABRA Mini A/B - Open Carriage Pleasure Driving {610670}
- 27WS. ABRA BBP Mini A/B - Open Carriage Pleasure Driving {810670}
- 118. Weanling Stallion, 30" & under {1074}
- 119. Yearling Stallion, 28" & under {1082}
- 120. Yearling Stallion, over 28" up to & including 30" {1084}
- 121. Yearling Stallion, over 30" up to & including 32" {1085}
- 122. Two Year Old Stallion, 29" & under {1091}
- 123. Two Year Old Stallion, over 29" up to & including 31" {1092}
- 124. Two Year Old Stallion, over 31" up to & including 33" {1093}
- 125. **Grand and Reserve Champion Junior Stallion** {1457} (1st & 2nd in Classes 118-124)

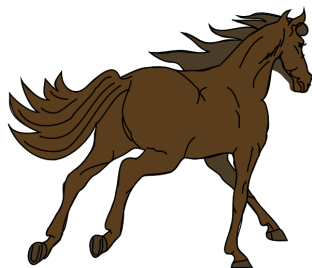

**Sunday - Continued:**

- 44. Youth Roadster, 18 years & under {1206}
- 45. Amateur Roadster {1209}
- 46. Ladies' Roadster {1210}
- 47. Gentlemen's Roadster {1211}
- 48. Open Roadster {1215}
- 49. **Grand and Reserve Champion Roadster Driving** {1333} (1st & 2nd in Classes 44-48)
  - 8WS. ABRA Mini A/B - Open Roadster {610008}
  - 9WS. ABRA BBP Mini A/B - Open Roadster {810008}
- 50. Novice Halter Gelding - Any Age Novice Exhibitor\*
- 51. PeeWee Youth, 6 years & under, Exhibiting a Mare or Gelding\*
- 52. Youth Special Needs Halter, 18 years & under - Exhibiting a Mare or Gelding {1256}
- 53. Adult Special Needs Halter Exhibiting a Mare or Gelding {1257}
- 54. Youth Halter Gelding, 7 years & under {1107}
- 55. Youth Halter Gelding, 8 - 12 years {1108}
- 56. Youth Halter Gelding, 13 - 18 years {1109}
- 57. Youth Stock Type Gelding, All Ages; 18 years & under {1416}
- 58. Amateur Junior Gelding, 33" & under, Level 1 {1159}
- 59. Amateur Junior Gelding, 33" & under, Level 2 {1160}
- 60. AOTE Junior Gelding, 33" & under {1301}
- 61. Weanling, 30" & under; and Yearling, 32" & under Gelding {1113}
- 62. Two Year Old Gelding, 33" & under {1116}
- 63. **Grand and Reserve Champion Junior Gelding** {1455} (1st & 2nd in Classes 61 & 62)
- 64. Youth Single Pleasure Driving, 18 years & under {1218}
- 65. Single Pleasure Driving Mare {1231}
- 66. Single Pleasure Driving Gelding {1232}
- 67. Single Pleasure Driving Stallion {1230}
- 68. Amateur Single Pleasure Driving, Level 1 {1224}
- 69. AOTE Single Pleasure Driving {1313}
- 70. Amateur Single Pleasure Driving, Level 2 {1225}
- 71. Single Pleasure Driving, 32" & under {1234}
- 72. Single Pleasure Driving, over 32" to 34" {1235}
- 73. Single Pleasure Driving, 3 & 4 year old {1358}
- 74. Ladies' Single Pleasure Driving {1228}
- 75. Gentlemen's Single Pleasure Driving {1229}
- 76. **Grand and Reserve Champion Single Pleasure Driving** {1335} (1&2 in Classes 64 - 75)
  - 10WS. ABRA Mini A/B - Open Single Pleasure Driving {610671}
  - 11WS. ABRA BBP Mini A/B - Open Single Pleasure Driving {810671}
- 77. Amateur Senior Gelding, 30" & under, Level 1 {1166}
- 78. Amateur Senior Gelding, over 30" up to & including 34", Level 1 {1167}
- 79. Amateur Senior Gelding, 30" & under, Level 2 {1164}
- 80. Amateur Senior Gelding, over 30" up to & including 34", Level 2 {1165}
- 81. AOTE Senior Gelding, 34" & under {1302}
- 82. **Grand & Reserve Champion Amateur Gelding** {1450} (1st & 2nd in Classes 58-60&77-81)
- 83. Amateur Stock Type Gelding; All Ages - 34" & under {1419}
- 84. Stock Type Gelding; All Ages - 34" & under {1422}
- 85. Senior Gelding, 30" & under {1119}
- 86. Senior Gelding, over 30" up to & including 32" {1118}
- 87. Senior Gelding, over 32" up to & including 34" {1117}
- 88. **Grand and Reserve Champion Senior Gelding** {1456} (1st & 2nd in Classes 85-87)
  - 12WS. ABRA Mini A/B - Open Halter Geldings (All Ages) {610110}
  - 13WS. ABRA BBP Mini A/B - Open Halter Geldings (All Ages) {810110}



The Heart Of Oklahoma Expo Center is located 4 miles South off of I-40 (Exit 181) & Hwy. 177; the turn East at the stop light on Leo Street. The exact address is 1700 West Independence Street, Shawnee, OK. There is a downloadable map on the Expo Center website - [www.ShawneeExpo.com](http://www.ShawneeExpo.com). The map to the right is a view of the Expo Center, showing the location of the barns and RV parking. The RV spots to the West of the Expo are 30 amp only, they have water but no dump stations. All of the other spots are 30 & 50 amp, with water and dump facilities. There are also several comfort stations with showers in the RV areas.

The Hampton Inn Shawnee - is our host hotel. It is located at 4851 North Kickapoo St. (Exit 185), off of I-40. It is on the south side of I-40, approximately 4 miles from the Expo Center. There is a free hot breakfast buffet, and free Wi-Fi. They do allow service pets for an extra charge. All rooms have a coffee maker, an iron/ironing board, hair dryer, microwave and refrigerator. The hotel has an indoor pool and fitness center, business center, laundry services.

Near the hotel there is a Wal-Mart Super Center along with various other types of stores for your shopping needs or pleasure. There are also other grocery and convenience stores nearby.

As for dining, there are several restaurants - Cracker Barrel, IHOP and McDonalds are near the hotel and near the Expo Center there is Bandana Red's Steakhouse and Abuelita Rosa's Mexican Restaurant. Throughout the town there are Steakhouses, Italian, Mexican, BBQ, Asian, Seafood as well as home style American cooking and other local fares for you to choose from; and many choices of fast food restaurants.

For specialized shopping there is Shawnee Mill & Feed Center, Tractor Supply, S&S Farm Center, Atwood's, PetSmart, Lowes and Tener's Western Outfitters nearby. There are also a lot of thrift shops, antique shops, and local shopping malls.

The first buildings on the town site were built in 1881, with a Quaker Mission being built in 1885. The town itself was founded in 1893. The railroad arrived in 1895 and the city prospered with the oil boom of the 1920's.

The area surrounding Shawnee was settled after the Civil War by a number of tribes that the federal government had removed to Indian Territory. The Sac & Fox were originally deeded the land in the immediate area but were soon followed by the Kickapoo, Shawnee and Pottawatomie Indians.

Shawnee is the county seat and also the home Oklahoma Baptist University (1910) and St. Gregory's University (1875). Located in the heart of cotton, potato and peach country, Shawnee quickly became an agricultural center.

Famous people from Shawnee include Brad Pitt, Astronaut Gordon Cooper, Dr. Brewster Higley, VI - author of "Home On The Range" and athletes Jim Thorpe, Creed Humphrey and Carl Hubbell (Hubbell telescope).

For other entertainment, there is the Santa Fe Depot/Pottawatomie Co. Museum, The Citizen Pottawatomie Nation Cultural Heritage Center, the Mabee-Gerrert Museum of Art, the Shawnee Little Theatre and the Cinema 8 Movie Theater. There are 2 bowling alleys and golf and there are 5 casinos in Shawnee: Black Hawk, Fire Lake, The Grand, Kickapoo and the Thunderbird.

We hope you will enjoy your time in Shawnee!

## Heart Of Oklahoma Expo

The Expo Center arena is not climate controlled, but there are the big fans in and around the arena for air circulation. The stalls have concrete flooring; with restrooms nearby. There are three large separate driving warm-up areas, several indoor wash racks and an enclosed concession area. There are also MANY RV spots available, some with comfort stations and showers.

Please be courteous, due to the fact we may have to share the grounds with other events, please park trailers in the north, west or south lots, vehicles ONLY in the east lot.

Please remember to keep the facility nice, **Absolutely NOTHING** may be **TAPED**, **STAPLED**, or **NAILED** onto ANY surface, including stalls, on the grounds except for the designated bulletin boards; otherwise fines will be imposed. Please place trash and manure in the dumpsters provided outside. Stall decorations are encouraged.

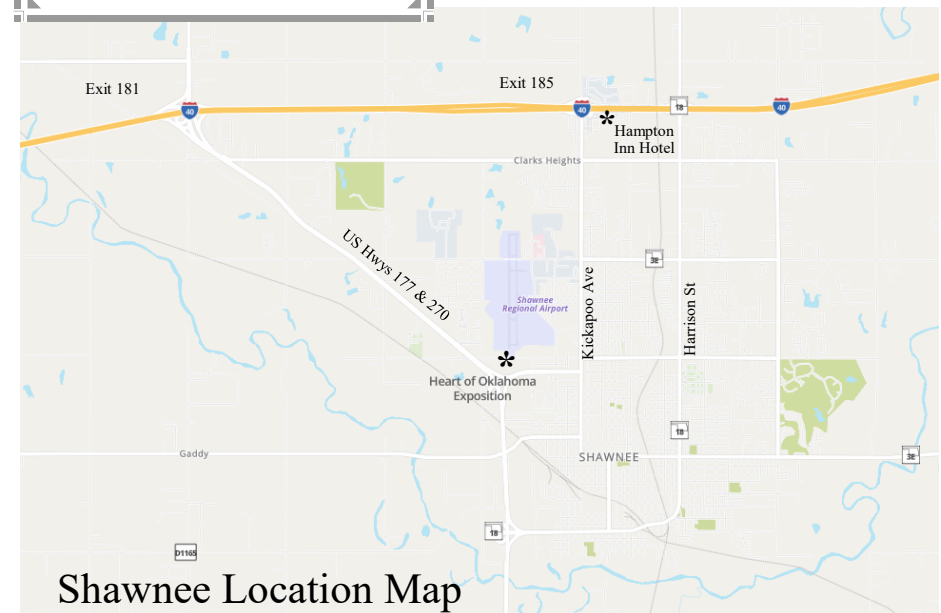
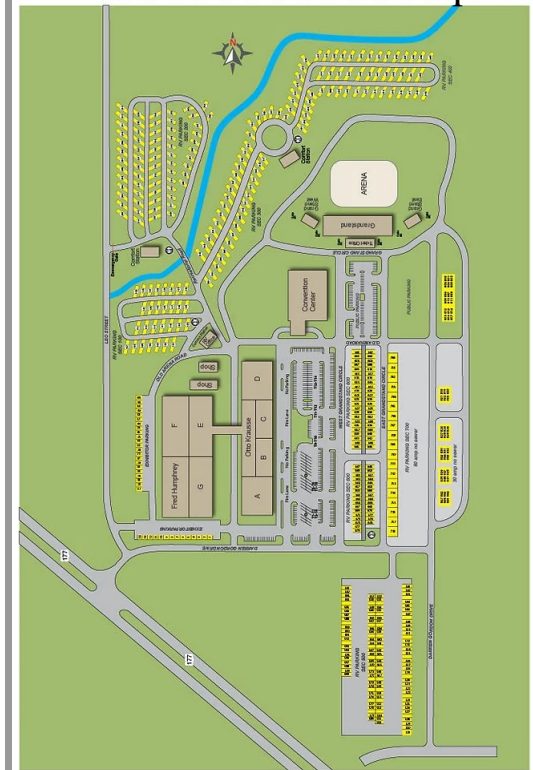

Shawnee Location Map